

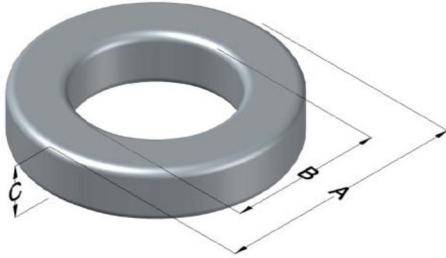

**0055035AY**

110 Delta Drive  
 Pittsburgh, PA 15238  
 NAFTA Sales: (1)800-245-3984  
 HK Sales : (852)3102-9337  
 magnetics@spang.com  
 www.mag-inc.com



MPP Permeability ( $\mu$ )	$A_L$ (nH/T <sup>2</sup> )	Core Marking			Coating Color
		Lot Number	Part Number	Inductance Grade	
300	159 $\pm$ 8%	N/A	N/A	N/A	Clear

Dimensions	Uncoated		Coated Limits			Packaging
	(mm)	(in)	(mm)	(in)		
OD (A)	10.16	0.400	10.62	0.418	max	Bulk Pack 4 bags/box Box Qty= 8000 pcs
ID (B)	5.08	0.200	4.75	0.187	min	
HT (C)	3.96	0.156	4.42	0.174	max	

Electrical Characteristics			Physical Characteristics						
Watt Loss @ 100 kHz, 100mT max(mW/cm <sup>3</sup> )	DC Bias min (oersteds)		Voltage Breakdown wire to wire min (V <sub>AC</sub> )	Break Strength min (kg)	Window Area W <sub>A</sub> (mm <sup>2</sup> )	Cross Section A <sub>e</sub> (mm <sup>2</sup> )	Path Length L <sub>e</sub> (mm)	Volume V <sub>e</sub> (mm <sup>3</sup> )	Weight (g)
	1050	80%							
	8.50	17.5							

Winding Information					Temperature Rating			
Winding Length Per Turn				Wound Coil Dimensions (mm)			Curie Temp: 460°C	
Winding Factor	(mm)	Winding Factor	(mm)	40% Winding Factor	OD	11.5		
					HT	5.96		
0%	15.4	40%	17.8	Completely Full Window	Max OD	14.1		
					Max HT	8.46		
20%	16.6	45%	18.1	Surface Area (mm <sup>2</sup> )				
25%	16.9	50%	18.4					
30%	17.1	60%	19.2	Unwound Core		370		
35%	17.5	70%	20.0	40% Winding Factor		480		
Notes:								Parylene coated, color appears clear to milky white.

