

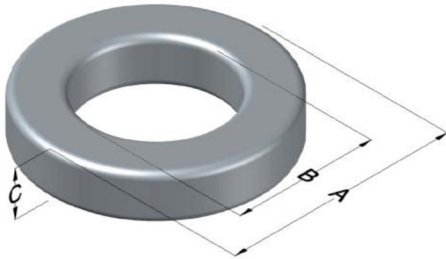

0055288AY

110 Delta Drive
 Pittsburgh, PA 15238
 NAFTA Sales: (1)800-245-3984
 HK Sales : (852)3102-9337
 magnetics@spang.com
 www.mag-inc.com



MPP Permeability (μ)	A_L (nH/T ²)	Core Marking			Coating Color
		Lot Number	Part Number	Inductance Grade	
160	84 ± 8%	N/A	N/A	N/A	Clear

Dimensions	Uncoated		Coated Limits			Packaging
	(mm)	(in)	(mm)	(in)		
OD (A)	9.65	0.380	10.11	0.398	max	Bulk Pack 4 bags/box Box Qty= 8000 pcs
ID (B)	4.78	0.188	4.45	0.175	min	
HT (C)	3.96	0.156	4.42	0.174	max	

Electrical Characteristics			Physical Characteristics						
Watt Loss @ 100 kHz, 100mT max(mW/cm ³)	DC Bias min (oersteds)		Voltage Breakdown wire to wire min (V _{AC})	Break Strength min (kg)	Window Area W _A (mm ²)	Cross Section A _e (mm ²)	Path Length L _e (mm)	Volume V _e (mm ³)	Weight (g)
	80%	50%							
900	21.0	39.0	600	6.3	15.5	9.45	21.8	206	1.8360

Winding Information					Temperature Rating			
Winding Length Per Turn				Wound Coil Dimensions (mm)		Curie Temp: 460°C		
Winding Factor	(mm)	Winding Factor	(mm)	40% Winding Factor		Coating Temp (Continuous up to): 130°C		
				OD	11.0	Notes:		
				HT	5.96		Parylene coated, color appears clear to milky white.	
				Completely Full Window		Max OD		13.4
				Max HT	8.20			
0%	15.2	40%	17.4	Surface Area (mm ²)				
20%	16.4	45%	17.8	Unwound Core		350		
25%	16.6	50%	18.1	40% Winding Factor		450		
30%	16.9	60%	18.7					
35%	17.2	70%	19.5					

Typical DC Bias Performance

