

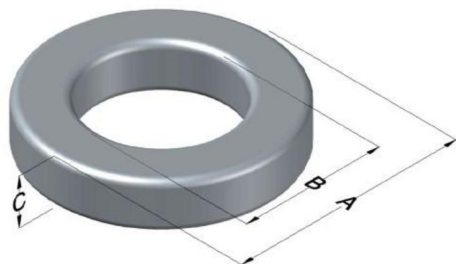

0076056A7

110 Delta Drive
 Pittsburgh, PA 15238
 NAFTA Sales: (1)800-245-3984
 HK Sales : (852)3102-9337
 magnetics@spang.com
 www.mag-inc.com



Kool M μ Hf Permeability (μ)	A _L (nH/T ²)	Core Marking			Coating Color
		Lot Number	Part Number	Inductance Grade	
40	18 \pm 8%	XXXXXX	76056A7	N/A	Black

Dimensions					Packaging		
Uncoated			Coated Limits		Bulk Pack 4 bags/box Box Qty = 5000 Pcs		
	(mm)	(in)	(mm)	(in)			
OD (A)	12.70	0.500	13.46	0.530			max
ID (B)	7.62	0.300	6.99	0.275			min
HT (C)	4.75	0.187	5.51	0.217	max		

Electrical Characteristics			Physical Characteristics						
Watt Loss @ 100kHz, 100mT (max, mW/cm ³)	DC Bias min (Oersteds)		Voltage Breakdown wire-to-wire min (V _{AC})	Break Strength (min, kg)	Window Area, W _A (mm ²)	Cross Section, A _e (mm ²)	Path Length, L _e (mm)	Volume V _e (mm ³)	Weight (g)
	80%	50%							
500	75.0	145	1250	14.9	38.3	10.9	31.2	340	3.38

Winding Information					Temperature Rating			
Winding Length per Turn				Wound Coil Dimensions (mm)		Curie Temp (°C):	500 °C	
Winding Factor	(mm)	Winding Factor	(mm)	40% Winding Factor	OD	14.6		
					HT	7.66		
0%	17.5	40%	21.1	Completely Full Window	Max OD	18.2		
20%	19.3	45%	21.7		Max HT	11.5		
25%	19.8	50%	22.1	Surface Area (mm ²)				
30%	20.1	60%	23.2	Unwound Core:	560			
35%	20.7	70%	24.5	40% Wound:	800			
							Coating Temp: (Continuous, up to; °C)	200 °C
							Notes:	

Typical DC Bias Performance

