

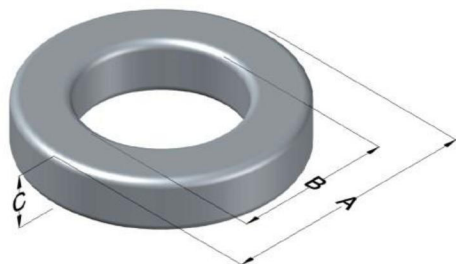

0076122A7

110 Delta Drive
 Pittsburgh, PA 15238
 NAFTA Sales: (1)800-245-3984
 HK Sales : (852)3102-9337
 magnetics@spang.com
 www.mag-inc.com



Kool M μ Hf Permeability (μ)	A _L (nH/T ²)	Core Marking			Coating Color
		Lot Number	Part Number	Inductance Grade	
26	15 \pm 8%	XXXXXX	76122A7	N/A	Black

Dimensions						Packaging
Uncoated			Coated Limits			
	(mm)	(in)	(mm)	(in)		
OD (A)	16.59	0.653	17.27	0.680	max	
ID (B)	10.16	0.400	9.53	0.375	min	
HT (C)	6.35	0.250	7.11	0.280	max	

Cardboard cut-outs
Box Qty = 2000 Pcs

Electrical Characteristics			Physical Characteristics						
Watt Loss @ 100kHz, 100mT (max, mW/cm ³)	DC Bias min (Oersteds)		Voltage Breakdown wire-to-wire min (V _{AC})	Break Strength (min, kg)	Window Area, W _A (mm ²)	Cross Section, A _e (mm ²)	Path Length, L _e (mm)	Volume V _e (mm ³)	Weight (g)
	80%	50%							
550	130	245	1250	23.1	71.2	19.2	41.2	791	4.7

Winding Information					Temperature Rating		
Winding Length per Turn				Wound Coil Dimensions (mm)		Curie Temp (°C):	500 °C
Winding Factor	(mm)	Winding Factor	(mm)	40% Winding Factor	OD		
0%	22.0	40%	26.8	Completely Full Window	18.8	Coating Temp: (Continuous, up to; °C)	200 °C
20%	24.4	45%	27.6		HT		
25%	25.0	50%	28.3	Surface Area (mm ²)	Max OD	Notes:	
30%	25.6	60%	29.7		Max HT		
35%	26.2	70%	31.4	Unwound Core:	920		
				40% Wound:	1300		

