

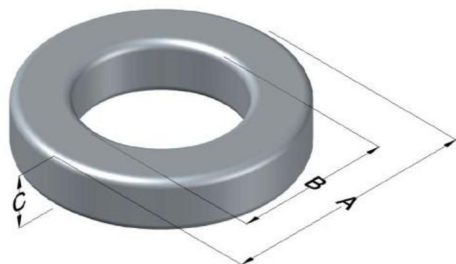

**0076326A7**

110 Delta Drive  
 Pittsburgh, PA 15238  
 NAFTA Sales: (1)800-245-3984  
 HK Sales : (852)3102-9337  
 magnetics@spang.com  
 www.mag-inc.com



Kool M $\mu$ Hf Permeability ( $\mu$ )	$A_L$ (nH/T <sup>2</sup> )	Core Marking			Coating Color
		Lot Number	Part Number	Inductance Grade	
26	24 $\pm$ 8%	XXXXXX	76326A7	N/A	Black

Dimensions					Packaging
Uncoated			Coated Limits		
	(mm)	(in)	(mm)	(in)	
OD (A)	35.81	1.410	36.70	1.445	max
ID (B)	22.35	0.880	21.54	0.848	min
HT (C)	10.46	0.412	11.35	0.447	max

Cardboard cut-outs  
Box Qty = 220 Pcs

Electrical Characteristics			Physical Characteristics						
Watt Loss @ 100kHz, 100mT (max, mW/cm <sup>3</sup> )	DC Bias min (Oersteds)		Voltage Breakdown wire-to-wire min (V <sub>AC</sub> )	Break Strength (min, kg)	Window Area, W <sub>A</sub> (mm <sup>2</sup> )	Cross Section, A <sub>e</sub> (mm <sup>2</sup> )	Path Length, L <sub>e</sub> (mm)	Volume V <sub>e</sub> (mm <sup>3</sup> )	Weight (g)
	80%	50%							
550	130	245	3000	80	364	67.8	89.8	6090	35.9

Winding Information					Temperature Rating		
Winding Length per Turn				Wound Coil Dimensions (mm)		Curie Temp (°C):	500 °C
Winding Factor	(mm)	Winding Factor	(mm)	40% Winding Factor	OD	40.2	
					HT	18.4	
0%	37.9	40%	48.9	Completely Full Window	Max OD	51.1	
20%	43.5	45%	50.6		Max HT	29.6	
25%	44.8	50%	52.0	Surface Area (mm <sup>2</sup> )			
30%	46.0	60%	55.5	Unwound Core:	3400		
35%	47.6	70%	59.3	40% Wound:	5700		

Coating Temp: (Continuous, up to; °C) 200 °C

Notes:

