

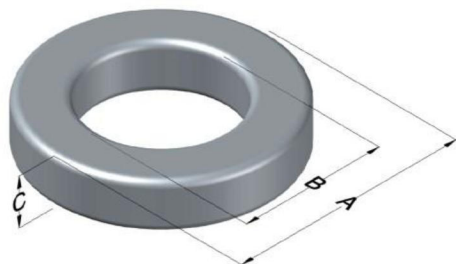

**0076586A7**

110 Delta Drive  
 Pittsburgh, PA 15238  
 NAFTA Sales: (1)800-245-3984  
 HK Sales : (852)3102-9337  
 magnetics@spang.com  
 www.mag-inc.com



Kool M $\mu$ Hf Permeability ( $\mu$ )	A <sub>L</sub> (nH/T <sup>2</sup> )	Core Marking			Coating Color
		Lot Number	Part Number	Inductance Grade	
60	28 $\pm$ 8%	XXXXXX	76586A7	N/A	Black

Dimensions					Packaging
Uncoated			Coated Limits		
	(mm)	(in)	(mm)	(in)	
OD (A)	34.29	1.350	35.18	1.385	
ID (B)	23.37	0.920	22.56	0.888	
HT (C)	8.89	0.350	9.78	0.385	

Electrical Characteristics			Physical Characteristics						
Watt Loss @ 100kHz, 100mT (max, mW/cm <sup>3</sup> )	DC Bias min (Oersteds)		Voltage Breakdown wire-to-wire min (V <sub>AC</sub> )	Break Strength (min, kg)	Window Area, W <sub>A</sub> (mm <sup>2</sup> )	Cross Section, A <sub>e</sub> (mm <sup>2</sup> )	Path Length, L <sub>e</sub> (mm)	Volume V <sub>e</sub> (mm <sup>3</sup> )	Weight (g)
	80%	50%							
450	45	100	3000	53.5	399	46.4	89.5	4150	26.9

Winding Information					Temperature Rating				
Winding Length per Turn				Wound Coil Dimensions (mm)		Curie Temp (°C):	500 °C		
Winding Factor	(mm)	Winding Factor	(mm)	40% Winding Factor	OD	40.5	Coating Temp: (Continuous, up to; °C)	200 °C	
					HT	16.8			
0%	32.2	40%	44.0	Completely Full Window	Max OD	50.1	Notes:		
20%	38.1	45%	45.6		Max HT	29.0			
25%	39.6	50%	47.3	Surface Area (mm <sup>2</sup> )					
30%	40.6	60%	50.8	Unwound Core:	2900				
35%	42.5	70%	54.9	40% Wound:	5500				

