

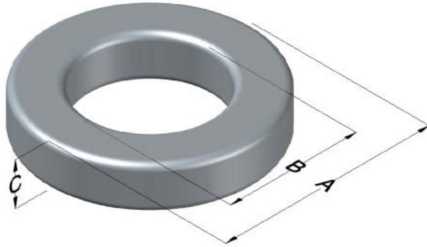

**0076894A7HT19**

110 Delta Drive  
 Pittsburgh, PA 15238  
 NAFTA Sales: (1)800-245-3984  
 HK Sales : (852)3102-9337  
 magnetics@spang.com  
 www.mag-inc.com



Kool M $\mu$ Hf Permeability ( $\mu$ )	A <sub>L</sub> (nH/T <sup>2</sup> )	Core Marking			Coating Color
		Lot Number	Part Number	Inductance Grade	
60	120 $\pm$ 8%	XXXXXX	76894A7HT19	N/A	Black

Dimensions	Uncoated		Coated Limits		Packaging
	(mm)	(in)	(mm)	(in)	
OD (A)	26.92	1.060	27.69	1.090	Cardboard cut-outs Box Qty= 280 pcs
ID (B)	14.73	0.580	14.10	0.555	
HT (C)	17.90	0.704	19.00	0.748	

Electrical Characteristics			Physical Characteristics						
Watt Loss @ 100 kHz, 100mT max (mW/cm <sup>3</sup> )	DC Bias min (oersteds)		Voltage Breakdown wire to wire min (V <sub>AC</sub> )	Break Strength min (kg)	Window Area W <sub>A</sub> (mm <sup>2</sup> )	Cross Section A <sub>e</sub> (mm <sup>2</sup> )	Path Length L <sub>e</sub> (mm)	Volume V <sub>e</sub> (mm <sup>3</sup> )	Weight (g)
	450	80% 45							

Winding Information					Temperature Rating	
Winding Length Per Turn				Wound Coil Dimensions (mm)		Curie Temp: 500°C
Winding Factor	(mm)	Winding Factor	(mm)	40% Winding Factor		Coating Temp (Continuous up to): 200°C
				OD	30.0	
				HT	23.5	Notes:
				Max OD	37.3	
				Max HT	31.0	
0%	51.6	40%	58.8	Completely Full Window		
20%	55.1	45%	59.8	Surface Area (mm <sup>2</sup> )		
25%	56.0	50%	60.7			
30%	56.9	60%	62.9	Unwound Core	3,400	
35%	57.8	70%	65.4	40% Winding Factor	4,500	

**Typical DC Bias Performance**

