

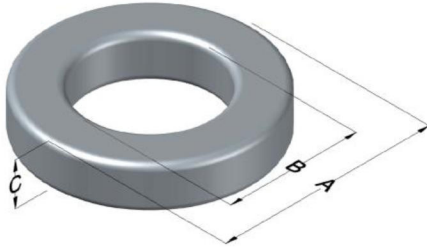

**0078452A7**

110 Delta Drive  
 Pittsburgh, PA 15238  
 NAFTA Sales: (1)800-245-3984  
 HK Sales : (852)3102-9337  
 magnetics@spang.com  
 www.mag-inc.com



XFLUX Permeability ( $\mu$ )	$A_L$ (nH/T <sup>2</sup> )	Core Marking			Coating Color
		Lot Number	Part Number	Inductance Grade	
75	135 ± 8%	XXXXXX	78452A7	N/A	Brown

Dimensions	Uncoated		Coated Limits			Packaging
	(mm)	(in)	(mm)	(in)		
OD (A)	42.90	1.689	43.84	1.726	max	Cardboard cut-outs Box Qty= 120 pcs
ID (B)	24.21	0.953	23.39	0.921	min	
HT (C)	16.26	0.640	17.27	0.680	max	

Electrical Characteristics			Physical Characteristics						
Watt Loss @ 50 kHz, 100mT max (mW/cm <sup>3</sup> )	DC Bias min (oersteds)		Voltage Breakdown wire to wire min (V <sub>AC</sub> )	Break Strength min (kg)	Window Area W <sub>A</sub> (mm <sup>2</sup> )	Cross Section A <sub>e</sub> (mm <sup>2</sup> )	Path Length L <sub>e</sub> (mm)	Volume V <sub>e</sub> (mm <sup>3</sup> )	Weight (g)
	80%	50%							
850	63	120	3000	98.8	430	147.5	102	15100	105

Winding Information					Temperature Rating	
Winding Length Per Turn				Wound Coil Dimensions (mm)		Curie Temp: 700°C
Winding Factor	(mm)	Winding Factor	(mm)	40% Winding Factor	OD	47.6
					HT	24.6
0%	55.0	40%	67.1	Completely Full Window	Max OD	59.4
					Max HT	36.7
20%	61.1	45%	68.9	Surface Area (mm <sup>2</sup> )		Notes:
25%	62.5	50%	70.8	Unwound Core		
30%	63.8	60%	74.2	40% Winding Factor		
35%	65.6	70%	78.5			

