

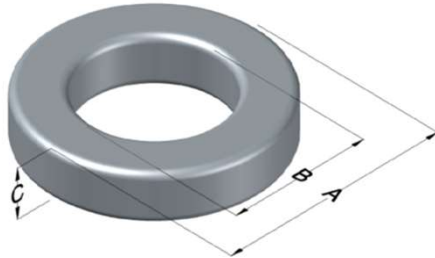

0078719A7X2

110 Delta Drive
 Pittsburgh, PA 15238
 NAFTA Sales: (1)800-245-3984
 HK Sales : (852)3102-9337
 magnetics@spang.com
 www.mag-inc.com



XFlux Permeability (μ)	A_L (nH/T ²)	Core Marking			Coating Color
		Lot Number	Part Number	Inductance Grade	
90	218 \pm 8%	XXXXXX	78719A7X2	N/A	Brown

Dimensions	Uncoated		Coated Limits			Packaging
	(mm)	(in)	(mm)	(in)		
OD (A)	50.80	2.000	51.99	2.047	max	TBD
ID (B)	31.75	1.250	30.34	1.194	min	
HT (C)	26.92	1.060	28.31	1.115	max	

Electrical Characteristics			Physical Characteristics						
Watt Loss @ 50kHz, 100mT max (mW/cm ³)	DC Bias min (oersteds)		Voltage Breakdown wire to wire min (V _{AC})	Break Strength min (kg)	Window Area W _a (mm ²)	Cross Section A _e (mm ²)	Path Length L _e (mm)	Volume V _e (mm ³)	Weight (g)
	80%	50%							
700	48	95	3000	93.0	723	245	127.3	31,200	240

Winding Information					Temperature Rating	
Winding Length Per Turn				Wound Coil Dimensions (mm)		Curie Temp: 700°C
Winding Factor	(mm)	Winding Factor	(mm)	40% Winding Factor	OD	58.4
					HT	37.9
0%	78.3	40%	93.8	Completely Full Window	Max OD	61.6
20%	86.1	45%	96.1		Max HT	50.7
25%	88.0	50%	98.3	Surface Area (mm ²)		
30%	89.5	60%	103	Unwound Core		10,000
35%	92.0	70%	108	40% Winding Factor		14,000
Coating Temp (Continuous up to): 200°C						
Notes:						

