

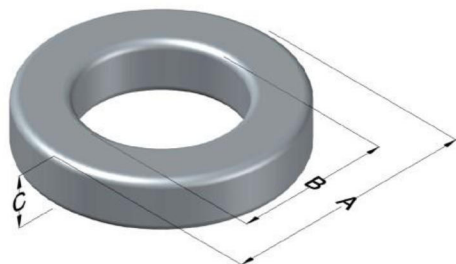

**0079441A7**

110 Delta Drive  
 Pittsburgh, PA 15238  
 NAFTA Sales: (1)800-245-3984  
 HK Sales : (852)3102-9337  
 magnetics@spang.com  
 www.mag-inc.com



Kool M $\mu$ MAX Permeability ( $\mu$ )	$A_L$ (nH/T <sup>2</sup> )	Core Marking			Coating Color
		Lot Number	Part Number	Inductance Grade	
14	32 $\pm$ 8%	XXXXXX	79441A7	N/A	Black

Dimensions					Packaging
Uncoated		Coated Limits			
	(mm)	(in)	(mm)	(in)	
OD (A)	46.74	1.840	47.63	1.875	Cardboard cut-outs Box Qty = 105 Pcs
ID (B)	24.13	0.950	23.32	0.918	
HT (C)	18.03	0.710	18.92	0.745	

Electrical Characteristics			Physical						
Watt Loss @ 100kHz, 100mT (max, mW/cm <sup>3</sup> )	DC Bias min. (Oe)		Voltage Breakdown wire-to-wire min (V <sub>AC</sub> )	Break Strength (min, kg)	Window Area, W <sub>A</sub> (mm <sup>2</sup> )	Cross Section, A <sub>e</sub> (mm <sup>2</sup> )	Path Length, L <sub>e</sub> (mm)	Volume V <sub>e</sub> (mm <sup>3</sup> )	Weight (g)
	80%	50%							
1200	225	420	3000	233	427	199	107	21300	134.8

Winding Information					Temperature Rating	
Winding Length per Turn			Wound Coil Dimensions (mm)		Curie Temp (°C):	500 °C
Winding Factor	(mm)	Winding Factor	(mm)	40% Winding Factor	OD	51.2
0%	62.1	40%	74.1	Completely Full Window	HT	26.0
20%	68.2	45%	76.0		Max OD	63.8
25%	69.7	50%	77.6	Surface Area (mm <sup>2</sup> )	Max HT	38.7
30%	70.9	60%	81.2		Unwound Core:	6900
35%	72.7	70%	85.4		40% Wound:	9600

