

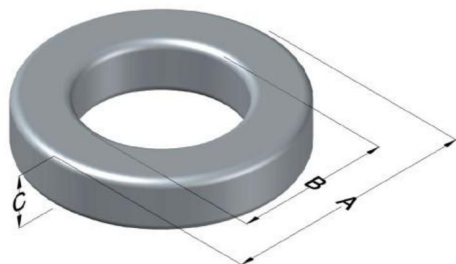

0079588A7

110 Delta Drive
 Pittsburgh, PA 15238
 NAFTA Sales: (1)800-245-3984
 HK Sales: (852)3102-9337
 magnetics@spang.com
 www.mag-inc.com



Kool M μ MAX Permeability (μ)	A_L (nH/T ²)	Core Marking			Coating Color
		Lot Number	Part Number	Inductance Grade	
14	9 \pm 8%	XXXXXX	79588A7	N/A	Black

Dimensions					Packaging
Uncoated			Coated Limits		
	(mm)	(in)	(mm)	(in)	
OD (A)	34.29	1.350	35.18	1.385	
ID (B)	23.37	0.920	22.56	0.888	
HT (C)	8.89	0.350	9.78	0.385	

Electrical Characteristics			Physical						
Watt Loss @ 100kHz 100mT (max, mW/cm ³)	DC Bias min (oersteds)		Voltage Breakdown wire-to-wire min (V _{AC})	Break Strength (min, kg)	Window Area, W _A (mm ²)	Cross Section, A _e (mm ²)	Path Length, L _e (mm)	Volume V _e (mm ³)	Weight (g)
	80%	50%							
1200	225	420	3000	53.5	399	46.4	89.5	4150	26.1

Winding Information					Temperature Rating		
Winding Length per Turn				Wound Coil Dimensions (mm)		Curie Temp (°C):	500 °C
Winding Factor	(mm)	Winding Factor	(mm)	40% Winding Factor	OD		
0%	32.2	40%	44.0	Completely Full Window	HT	Notes:	
20%	38.1	45%	45.6		Max OD		
25%	39.6	50%	47.3	Surface Area (mm ²)			
30%	40.6	60%	50.8	Unwound Core:		2900	
35%	42.5	70%	54.9	40% Wound:		5500	

