



Specification for:

**0J43813TC**

110 Delta Drive  
 Pittsburgh, PA 15238  
 Phone: 412/696-1333  
 Fax: 412/696-0333  
 Email: magnetics@spang.com

**DIMENSIONS**

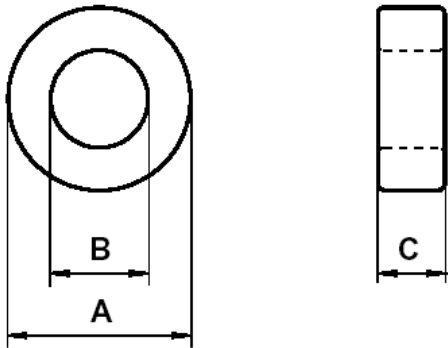

(mm)	Uncoated Nominal:	Min:	Max:
O.D. (A)	38.1	37.33	38.87
I.D. (B)	19	18.28	19.72
Ht. (C)	12.7	12.44	12.96

Eff. Parameters		
$A_e$ mm <sup>2</sup>	$l_e$ mm	$V_e$ mm <sup>3</sup>
115.6	82.9	9652

**INDUCTANCE**

$A_L$ value (nH/T <sup>2</sup> )	Test conditions	
8365 ± 20%	10 kHz	0.5 mT (For N = 1, use 4 mA), 25°C
≥ 0.9 x $A_L$ @ 10 kHz	200 kHz	

**ELECTRICAL LOSSES**

$\tan \delta / \mu_i$	Test conditions
≤ 15 · 10 <sup>-6</sup>	100 kHz, 0.5 mT, 25°C

**COATING**

Uncoated
----------

**NOTE**

Spec. Modifications	Previous	Revised
2006.01.13	LF: General J Material $A_L$ value up to 200 kHz	LF: Detail as indicated $A_L$ at 200 kHz ≥ 0.9 x $A_L$ at 10 kHz