

DIMENSIONS

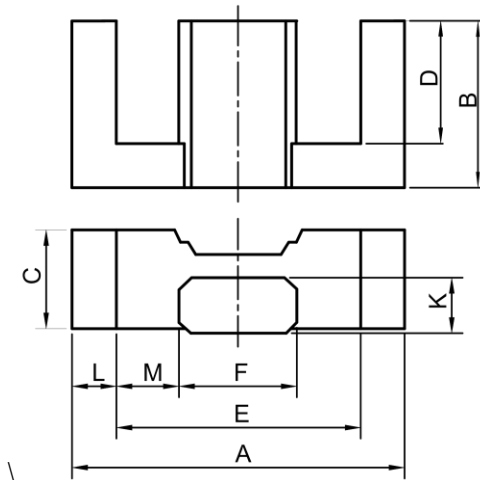

(mm)	Nominal:Tol.	min.:Tol.	max.: Tol
A	15.0	-0.4	+ 0.4
B	7.5	-0.15	+ 0.15
C	4.65	-0.15	+ 0.15
D	5.5	-0.25	+ 0.25
E	11.0	-0.35	+ 0.35
F	5.3	-0.15	+ 0.15
K	2.4	-0.1	+ 0.1
L	2.0 Nom		
M	2.85 Nom		
Eff. Parameters			
Ae mm²	Amin mm²	le mm	Ve mm³
15.0	12.2	34.0	510

INDUCTANCE

AL value (nH/T²)	Test conditions
330 ± 25%	10 kHz, < 0.5 mT, 25 °C

CORE LOSSES

P_L max	Test conditions
400 mW/cm ³ (0.204 W/set)	1000 kHz, 50 mT, 100 °C