

DIMENSIONS

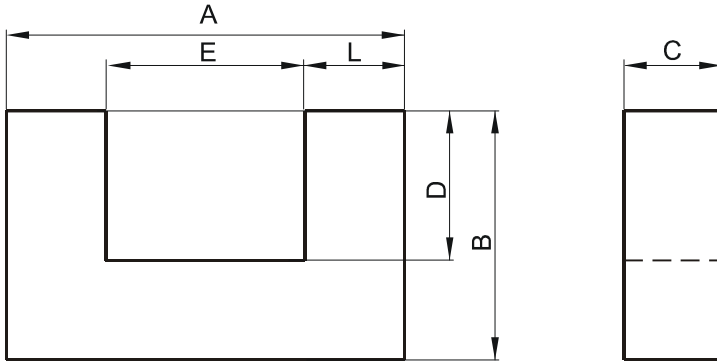

(mm)	Nominal:	Tol. min.:	Tol. max.:
A	25.4	-0.51	+ 0.51
B	15.9 Ref.		
C	6.35	-0.12	+ 0.12
D	9.27 Min.		
E	12.7 Ref.		
L	6.45	-0.15	+ 0.15
Eff. Parameters			
Ae mm²	Amin mm²	le mm	Ve mm³
40.4	40.4	83.4	3370

INDUCTANCE

MARKING

AL value (nH/T ²)	Test conditions	P UC
Nom: 1333 Min.: 1000	10 kHz, < 0.5 mT, 25 °C	

CORE LOSSES

P _i max	Test conditions
< 0.4 W/set (< 119 mW/cm ³)	100 kHz, 100 mT, 100 °C

NOTE

Spec. modifications	Previous	Revised
2005-06-22	L=6.35±0.13 Losses: General P material	L=6.45±0.15 Losses: Detail as indicated