

**DIMENSIONS**

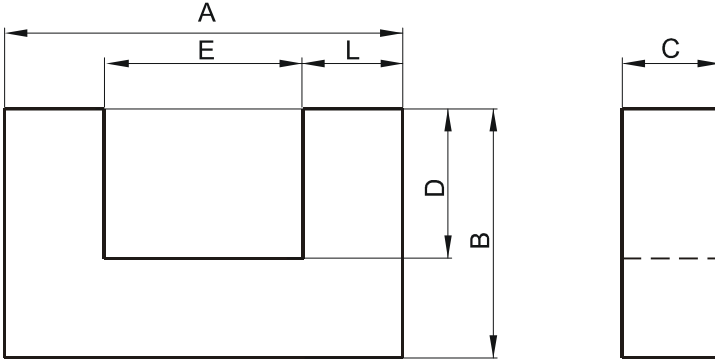

(mm)	Nominal:	Tol. min.:	Tol. max.:
<b>A</b>	93.0	-1.8	+ 1.8
<b>B</b>	76.0	-0.5	+ 0.5
<b>C</b>	32.0	-0.6	+ 0.6
<b>D</b>	48.0	-0.9	+ 0.9
<b>E</b>	36.2	-1.2	+ 1.2
<b>L</b>	28.4 Ref.		
Eff. Parameters			
Ae mm <sup>2</sup>	Amin mm <sup>2</sup>	le mm	Ve mm <sup>3</sup>
905	896	353	319000

**INDUCTANCE**

AL value (nH/T <sup>2</sup> )	Test conditions
Nom: 7700 Min.: 5775	10 kHz, < 0.5 mT, 25 °C

**MARKING**

P UC
---------

**REMARKS**

PI value measured on T25/15/10-P sintered together with 0P-49332-UC
---

**CORE LOSSES**

P <sub>i</sub> max	Test conditions
< 0.36 W (< 123 mW/cm <sup>3</sup> )	100 kHz, 100 mT, 100 °C

**NOTE**

Spec. modifications	Previous	Revised
2009-10-09		Issued