

**DIMENSIONS**

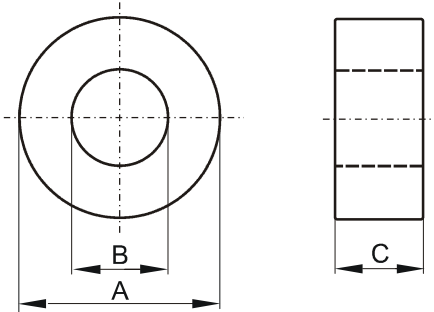

(mm)	Uncoated Nominal:	Min:	Max:
<b>O.D. (A)</b>	3.46	3.21	3.71
<b>I.D. (B)</b>	1.78	1.62	1.94
<b>Ht. (C)</b>	1.27	1.09	1.45
Eff. Parameters			
<b>Ae mm<sup>2</sup></b>	<b>le mm</b>	<b>Ve mm<sup>3</sup></b>	
1.03	7.65	7.87	

**INDUCTANCE**

AL value (nH/T <sup>2</sup> )	Test conditions
380 ± 25%	10 kHz, 0.5 mT (For N=5, use 0.16 mA), 25°C

**CORE LOSSES**

P <sub>i</sub> max	Production lot limit Max avg	Test conditions
< 0.90 mW (< 110 mW/cm <sup>3</sup> )	< 0.80 mW (< 100 mW/cm <sup>3</sup> )	100 kHz, 100 mT, 100 °C
< 5.70 mW (< 715 mW/cm <sup>3</sup> )	< 5.20 mW (< 650 mW/cm <sup>3</sup> )	100 kHz, 200 mT, 100 °C

**COATING**

Uncoated
----------

**NOTE**

Spec. modifications	Previous	Revised
2007-06-05	Losses: General R material	Losses: Detail as indicated