

Specification for:

0R42107EC

110 Delta Drive
Pittsburgh, PA 15238
Phone: 412/696-1333
Fax: 412/696-0333
Email: magnetics@spang.com

DIMENSIONS

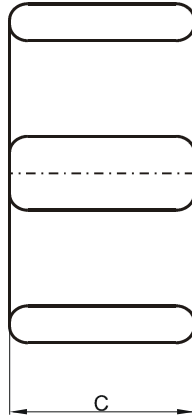
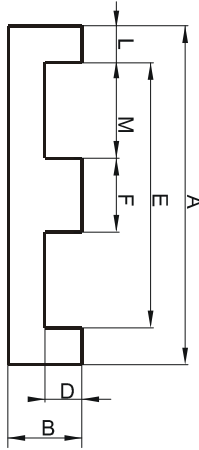

(mm)	Nominal:	Tol. min.:	Tol. max.:
A	21.8	-0.4	+ 0.4
B	3.91	-0.08	+ 0.08
C	7.8	-0.5	+ 0.5
D	1.73	-0.2	+ 0.2
E	16.8	-0.3	+ 0.3
F	5.0	-0.2	+ 0.2
L	2.5	-0.12	+ 0.12
M	5.89	-0.25	+ 0.25
Eff. Parameters			
Ae mm²	Amin mm²	le mm	Ve mm³
37.1	36	25.7	960

INDUCTANCE

AL value (nH)	Test conditions
Nom: 3448 Min.: 2586	10 kHz, < 0.5 mT, 25 °C

MARKING

R EC

CORE LOSSES

P _i max	Test conditions
87 mW/cm ³ (0.08 W/set)	100 kHz, 100 mT, 100 °C
580 mW/cm ³ (0.56 W/set)	100 kHz, 200 mT, 100 °C

NOTE

Spec. modifications	Previous	Revised
2005-06-22	B=3.84 Min. Losses: General R material	B=2.82 Min. Losses: Detail as indicated