

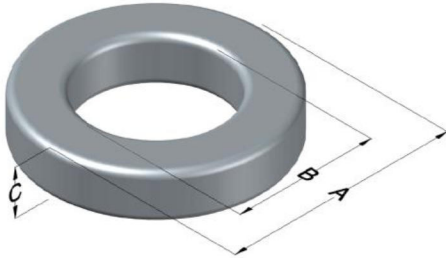

C055106W4

110 Delta Drive
 Pittsburgh, PA 15238
 NAFTA Sales: (1)800-245-3984
 HK Sales : (852)3102-9337
 magnetics@spang.com
 www.mag-inc.com



MPP Permeability (μ)	A_L (nH/T ²)	Core Marking			Coating Color
		Lot Number	Part Number	Inductance Grade	
200	250 \pm 8%	XXXXXX	55106W4	X	Gray

Dimensions	Uncoated		Coated Limits			Packaging
	(mm)	(in)	(mm)	(in)		
OD (A)	57.15	2.250	58.04	2.285	max	Cardboard cut-outs Box Qty= 90 pcs
ID (B)	35.56	1.400	34.75	1.368	min	
HT (C)	13.96	0.550	14.86	0.585	max	

Electrical Characteristics			Physical Characteristics						
Watt Loss @ 100 kHz, 100mT max(mW/cm ³)	DC Bias min (oersteds)		Voltage Breakdown wire to wire min (V _{AC})	Break Strength min (kg)	Window Area W _A (mm ²)	Cross Section A _e (mm ²)	Path Length L _e (mm)	Volume V _e (mm ³)	Weight (g)
	80%	50%							
1050	15.0	28.0	3000	107.0	948	144	143	20,700	190

Winding Information					Temperature Rating			
Winding Length Per Turn				Wound Coil Dimensions (mm)			Curie Temp: 460 °C	
Winding Factor	(mm)	Winding Factor	(mm)	40% Winding Factor		OD	63.5	
				HT	25.9			
0%	53.0	40%	71.0	Completely Full Window		Max OD	81.3	
20%	61.9	45%	73.2			Max HT	44.4	
25%	64.3	50%	76.0	Surface Area (mm ²)				Notes: W4 stabilization: Controlled stabilization with Inductance stability limits of +/- 0.25% over temperature range -55°C to +85°C measured at low drive level (<10mT). For power inductors use standard stabilization, A2.
30%	65.8	60%	81.3					
35%	68.7	70%	87.1	40% Winding Factor	13,000			

Typical DC Bias Performance

