

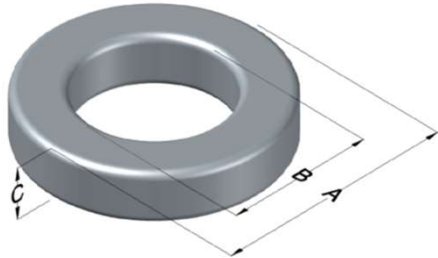

C055439A2X2

110 Delta Drive
 Pittsburgh, PA 15238
 NAFTA Sales: (1)800-245-3984
 HK Sales : (852)3102-9337
 magnetics@spang.com
 www.mag-inc.com



MPP Permeability (μ)	A_L (nH/T ²)	Core Marking			Coating Color
		Lot Number	Part Number	Inductance Grade	
60	270 \pm 8%	XXXXXX	55439A2X2	N/A	Grey

Dimensions	Uncoated		Coated Limits			Packaging
	(mm)	(in)	(mm)	(in)		
OD (A)	46.74	1.840	47.93	1.887	max	Cardboard cut-outs Box Qty = TBD
ID (B)	24.13	0.950	22.72	0.894	min	
HT (C)	36.06	0.710	37.45	1.474	max	

Electrical Characteristics			Physical Characteristics						
Watt Loss @ 100kHz, 100mT max (mW/cm ³)	DC Bias min (oersteds)		Voltage Breakdown wire to wire min (V _{AC})	Break Strength min (kg)	Window Area W _a (mm ²)	Cross Section A _e (mm ²)	Path Length L _e (mm)	Volume V _e (mm ³)	Weight (g)
	80%	50%							
700	50	94	3000	233.0	405	397	107.4	85,200	362

Winding Information					Temperature Rating	
Winding Length Per Turn				Wound Coil Dimensions (mm)		Curie Temp: 460°C
Winding Factor	(mm)	Winding Factor	(mm)	40% Winding Factor	OD	52.7
					HT	44.7
0%	100	40%	112	Completely Full Window	Max OD	52.7
20%	106	45%	113		Max HT	54.3
25%	107	50%	115	Surface Area (mm ²)		
30%	109	60%	119	Unwound Core		11,000
35%	110	70%	123	40% Winding Factor		14,000
Coating Temp (Continuous up to): 200°C						
Notes:						

