

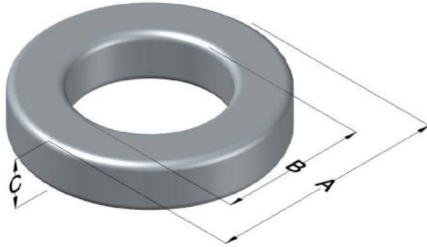

C055548A2HT19

110 Delta Drive
 Pittsburgh, PA 15238
 NAFTA Sales: (1)800-245-3984
 HK Sales : (852)3102-9337
 magnetics@spang.com
 www.mag-inc.com



MPP Permeability (μ)	A_L (nH/T ²)	Core Marking			Coating Color
		Lot Number	Part Number	Inductance Grade	
125	214 \pm 8%	XXXXXX	55548A2HT19	X	Gray

Dimensions	Uncoated		Coated Limits			Packaging
	(mm)	(in)	(mm)	(in)		
OD (A)	32.79	1.291	33.66	1.325	max	Cardboard cut-outs Box Qty= 175 pcs
ID (B)	20.09	0.791	19.46	0.766	min	
HT (C)	17.80	0.702	19	0.748	max	

Electrical Characteristics			Physical Characteristics						
Watt Loss @ 100 kHz, 100mT max (mW/cm ³)	DC Bias min (oersteds)		Voltage Breakdown wire to wire min (V _{AC})	Break Strength min (kg)	Window Area W _A (mm ²)	Cross Section A _e (mm ²)	Path Length L _e (mm)	Volume V _e (mm ³)	Weight (g)
	850	80% 25							

Winding Information					Temperature Rating			
Winding Length Per Turn				Wound Coil Dimensions (mm)			Curie Temp: 460 °C	
Winding Factor	(mm)	Winding Factor	(mm)	40% Winding Factor		OD	36.8	
						HT	25.3	
				Completely Full Window		Max OD	46.7	
						Max HT	35.5	
				Surface Area (mm ²)			Notes:	
				Unwound Core		4,400		
				40% Winding Factor		6,400		
0%	52.3	40%	62.2					
20%	57.2	45%	63.5					
25%	58.3	50%	64.9					
30%	59.6	60%	68.0					
35%	60.8	70%	71.4					

