

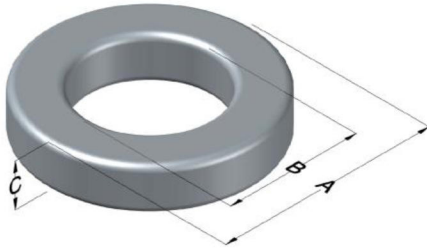

C058071A2HT15

110 Delta Drive
 Pittsburgh, PA 15238
 NAFTA Sales: (1)800-245-3984
 HK Sales : (852)3102-9337
 magnetics@spang.com
 www.mag-inc.com



High Flux Permeability (μ)	A_L (nH/T ²)	Core Marking			Coating Color
		Lot Number	Part Number	Inductance Grade	
60	80 ± 8%	XXXXXX	58071A2HT15	X	Khaki

Dimensions	Uncoated		Coated Limits			Packaging
	(mm)	(in)	(mm)	(in)		
OD (A)	32.79	1.291	33.66	1.325	max	Cardboard cut-outs Box Qty= 175 pcs
ID (B)	20.09	0.791	19.46	0.766	min	
HT (C)	14	0.551	15	0.590	max	

Electrical Characteristics			Physical Characteristics						
Watt Loss @ 100 kHz, 100mT max (mW/cm ³)	DC Bias min (oersteds)		Voltage Breakdown wire to wire min (V _{AC})	Break Strength min (kg)	Window Area W _A (mm ²)	Cross Section A _e (mm ²)	Path Length L _e (mm)	Volume V _e (mm ³)	Weight (g)
	80%	50%							
900	90	170	3000	79.0	297	86.0	81.4	7,000	54

Winding Information					Temperature Rating	
Winding Length Per Turn				Wound Coil Dimensions (mm)		Curie Temp: 500°C
Winding Factor	(mm)	Winding Factor	(mm)	40% Winding Factor		Coating Temp (Continuous up to): 200°C
				OD	36.8	Notes:
0%	44.3	40%	54.2	HT	21.3	
				Max OD	46.7	
20%	49.2	45%	55.5	Max HT	31.5	
25%	50.3	50%	56.9	Surface Area (mm ²)		
30%	51.6	60%	60.0	Unwound Core	3,700	
35%	52.8	70%	63.4	40% Winding Factor	5,800	

