

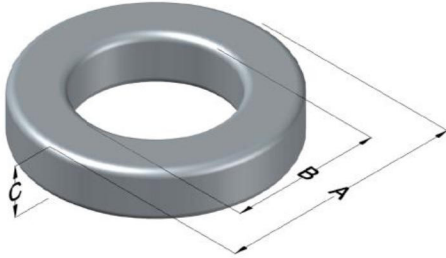

# C058192A2HT22

110 Delta Drive  
 Pittsburgh, PA 15238  
 NAFTA Sales: (1)800-245-3984  
 HK Sales : (852)3102-9337  
 magnetics@spang.com  
 www.mag-inc.com



High Flux Permeability ( $\mu$ )	$A_L$ (nH/T <sup>2</sup> )	Core Marking			Coating Color
		Lot Number	Part Number	Inductance Grade	
60	192 ± 8%	XXXXXX	58192A2HT22	X	Khaki

Dimensions	Uncoated		Coated Limits			Packaging
	(mm)	(in)	(mm)	(in)		
OD (A)	57.15	2.250	58.04	2.285	max	Cardboard cut-outs Box Qty= 60 pcs
ID (B)	26.39	1.039	25.58	1.007	min	
HT (C)	21.18	0.834	22.0	0.866	max	

Electrical Characteristics			Physical Characteristics						
Watt Loss @ 100 kHz, 100mT max (mW/cm <sup>3</sup> )	DC Bias min (oersteds)		Voltage Breakdown wire to wire min (V <sub>AC</sub> )	Break Strength min (kg)	Window Area W <sub>A</sub> (mm <sup>2</sup> )	Cross Section A <sub>e</sub> (mm <sup>2</sup> )	Path Length L <sub>e</sub> (mm)	Volume V <sub>e</sub> (mm <sup>3</sup> )	Weight (g)
	80%	50%							
900	90.0	170	3000	163.0	514	318	125	39,800	295

Winding Information					Temperature Rating	
Winding Length Per Turn				Wound Coil Dimensions (mm)		Curie Temp: 500°C
Winding Factor	(mm)	Winding Factor	(mm)	40% Winding Factor		Coating Temp (Continuous up to): 200°C
				OD	62.0	
				HT	29.8	Notes:
				Completely Full Window		
				Max OD	75.7	
0%	76.5	40%	89.5	Max HT	39.8	
20%	82.8	45%	91.4	Surface Area (mm <sup>2</sup> )		
25%	84.5	50%	93.2	Unwound Core		
30%	86.1	60%	97.3	40% Winding Factor		
35%	87.9	70%	101.8	14,000		

### Typical DC Bias Performance

