

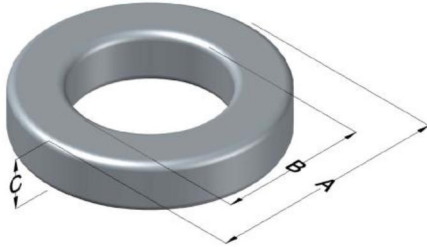

C058894A2HT34

110 Delta Drive
 Pittsburgh, PA 15238
 NAFTA Sales: (1)800-245-3984
 HK Sales : (852)3102-9337
 magnetics@spang.com
 www.mag-inc.com



High Flux Permeability (μ)	A_L (nH/T ²)	Core Marking			Coating Color
		Lot Number	Part Number	Inductance Grade	
60	225 ± 8%	XXXXXX	58894A2HT34	X	Khaki

Dimensions	Uncoated		Coated Limits			Packaging
	(mm)	(in)	(mm)	(in)		
OD (A)	26.92	1.060	27.69	1.090	max	Cardboard cut-outs Box Qty= 160 pcs
ID (B)	14.73	0.580	14.10	0.555	min	
HT (C)	33.53	1.320	34	1.338	max	

Electrical Characteristics			Physical Characteristics						
Watt Loss @ 100 kHz, 100mT max (mW/cm ³)	DC Bias min (oersteds)		Voltage Breakdown wire to wire min (V _{AC})	Break Strength min (kg)	Window Area W _A (mm ²)	Cross Section A _e (mm ²)	Path Length L _e (mm)	Volume V _e (mm ³)	Weight (g)
	80%	50%							
900	90	170	3000	77.0	156	196	63.5	12,400	95

Winding Information					Temperature Rating	
Winding Length Per Turn				Wound Coil Dimensions (mm)		Curie Temp: 500°C
Winding Factor	(mm)	Winding Factor	(mm)	40% Winding Factor		Coating Temp (Continuous up to): 200°C
				OD	30.0	Notes:
0%	81.6	40%	88.8	HT	38.5	
				Max OD	37.3	
20%	85.1	45%	89.8	Max HT	46.0	
25%	86.0	50%	90.7	Surface Area (mm ²)		
30%	86.9	60%	92.9	Unwound Core	5,400	
35%	87.8	70%	95.4	40% Winding Factor	6,400	

