

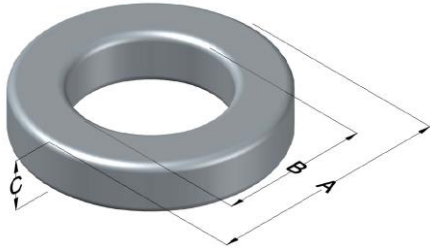

C058928A9

110 Delta Drive
 Pittsburgh, PA 15238
 NAFTA Sales: (1)800-245-3984
 HK Sales : (852)3102-9337
 magnetics@spang.com
 www.mag-inc.com



High Flux Permeability (μ)	A_L (nH/T ²)	Core Marking			Coating Color
		Lot Number	Part Number	Inductance Grade	
160	201 ± 8%	XXXXXX	58928A9	X	Khaki

Dimensions	Uncoated		Coated Limits			Packaging
	(mm)	(in)	(mm)	(in)		
OD (A)	26.92	1.060	28.07	1.105	max	Cardboard cut-outs Box Qty= 400 pcs
ID (B)	14.73	0.580	13.72	0.540	min	
HT (C)	11.18	0.440	12.32	0.485	max	

Electrical Characteristics			Physical Characteristics						
Watt Loss @ 100 kHz, 100mT max (mW/cm ³)	DC Bias min (oersteds)		Voltage Breakdown wire to wire min (V _{AC})	Break Strength min (kg)	Window Area W _A (mm ²)	Cross Section A _e (mm ²)	Path Length L _e (mm)	Volume V _e (mm ³)	Weight (g)
	80%	50%							
1500	32.0	60.0	8000	77.0	156	65.4	63.5	4,150	34.68

Winding Information					Temperature Rating	
Winding Length Per Turn				Wound Coil Dimensions (mm)		Curie Temp: 500°C
Winding Factor	(mm)	Winding Factor	(mm)	40% Winding Factor		Coating Temp (Continuous up to): 200°C
				OD	30.0	Notes:
				HT	16.5	
				Completely Full Window		
				Max OD	37.3	
				Max HT	24.0	
				Surface Area (mm ²)		
				Unwound Core	2,400	
				40% Winding Factor	3,500	
0%	37.5	40%	44.6			
20%	41.1	45%	45.7			
25%	41.9	50%	46.6			
30%	42.8	60%	48.8			
35%	43.8	70%	51.3			

