

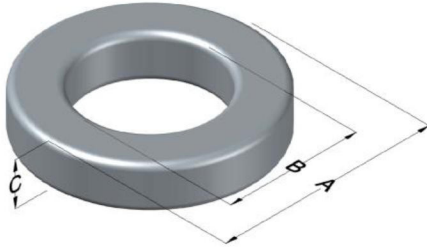

# C058930A2HT19

110 Delta Drive  
 Pittsburgh, PA 15238  
 NAFTA Sales: (1)800-245-3984  
 HK Sales : (852)3102-9337  
 magnetics@spang.com  
 www.mag-inc.com



High Flux Permeability ( $\mu$ )	$A_L$ (nH/T <sup>2</sup> )	Core Marking			Coating Color
		Lot Number	Part Number	Inductance Grade	
125	253 ± 8%	XXXXXX	58930A2HT19	X	Khaki

Dimensions	Uncoated		Coated Limits		Packaging
	(mm)	(in)	(mm)	(in)	
OD (A)	26.92	1.060	27.69	1.090	Cardboard cut-outs Box Qty= 280 pcs
ID (B)	14.73	0.580	14.10	0.555	
HT (C)	18	0.709	19	0.748	

Electrical Characteristics			Physical Characteristics						
Watt Loss @ 100 kHz, 100mT max (mW/cm <sup>3</sup> )	DC Bias min (oersteds)		Voltage Breakdown wire to wire min (V <sub>AC</sub> )	Break Strength min (kg)	Window Area W <sub>A</sub> (mm <sup>2</sup> )	Cross Section A <sub>e</sub> (mm <sup>2</sup> )	Path Length L <sub>e</sub> (mm)	Volume V <sub>e</sub> (mm <sup>3</sup> )	Weight (g)
	80%	50%							
1000	46	81	3000	77.0	156	105	63.5	6670	54

Winding Information					Temperature Rating		
Winding Length Per Turn				Wound Coil Dimensions (mm)		Curie Temp: 500°C	
Winding Factor	(mm)	Winding Factor	(mm)	40% Winding Factor	OD	30.0	
					HT	23.5	
				Completely Full Window	Max OD	37.3	
					Max HT	31.0	
0%	51.6	40%	58.8	Surface Area (mm <sup>2</sup> )			
20%	55.1	45%	59.8				
25%	56.0	50%	60.7	Unwound Core			
30%	56.9	60%	62.9				
35%	57.8	70%	65.4	40% Winding Factor			
				3,400			
				4,600			
							Coating Temp (Continuous up to): 200°C
							Notes:

