

DIMENSIONS

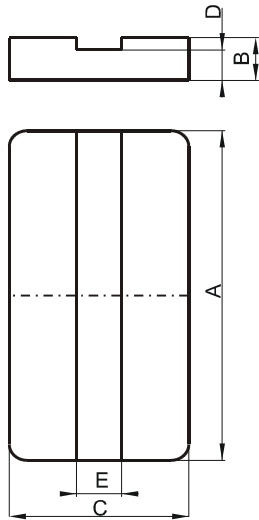

(mm)	Nominal:	Tol. min.:	Tol. max.:
A	20.0	-0.35	+ 0.35
B	2.3	-0.05	+ 0.05
C	14.0	-0.3	+ 0.3
D	1.9	-0.1	+ 0.1
E	3.0	-0.1	+ 0.1
Eff. Parameters (with C_42014EC)			
Ae mm²	Amin mm²	le mm	Ve mm³
59.8	55.0	25.1	1500

INDUCTANCE

MARKING

AL value (nH/T²)	Test conditions (with CR42014EC)
Nom: 4500 Min.: 3375	10 kHz, < 0.5 mT, 25 °C

R IC

CORE LOSSES

P_i max	Test conditions
89 mW/cm ³ (0.134 W/set)	100 kHz, 100 mT, 100 °C
616 mW/cm ³ (0.92 W/set)	100 kHz, 200 mT, 100 °C