

CT43208IC

DIMENSIONS

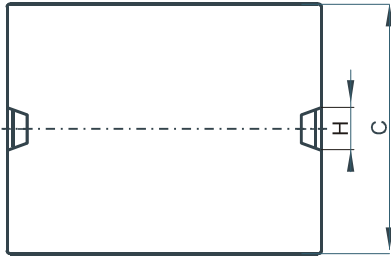
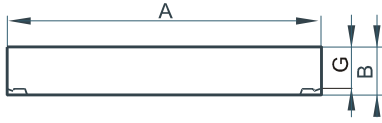

(mm)	Nominal:	Tol. min.:	Tol. max.:
A	31.75	-0.64	+ 0.64
B	3.18	-0.13	+ 0.13
C	20.32	-0.41	+ 0.41
G	2.13	-0.2	+ 0.2
H	5.0	0.0	+ 0.2
Eff. Parameters (with C_43208EC)			
Ae mm²	Amin mm²	le mm	Ve mm³
130.0	130.0	35.1	4560

INDUCTANCE

AL value (nH/T ²)	Test conditions (with CT43208EC)
Nom: 8520 Min.: 6390	10 kHz, < 0.5 mT, 25 °C

MARKING

CT43208IC
PXXXXXXXXX

CORE LOSSES

P _i max	Test conditions
< 2.5 W/set (< 560 mW/cm ³)	100 kHz, 200 mT, 100 °C
< 2.7 W/set (< 590 mW/cm ³)	100 kHz, 200 mT, 25 °C

NOTE

Spec. modifications	Previous	Revised
2013-07-01		Issued