

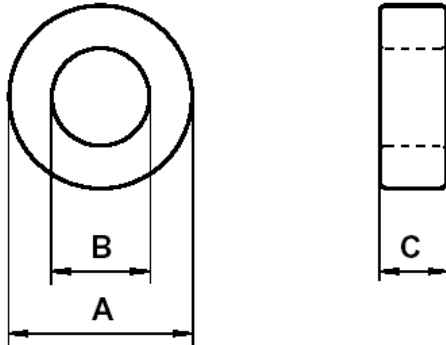

Specification for:
YF40200TC

110 Delta Drive
Pittsburgh, PA 15238
Phone: 412/696-1333
Fax: 412/696-0333
Email:magnetics@spang.com

DIMENSIONS



(mm)	Uncoated Nominal:	Coated Min:	Coated Max:
O.D. (A)	2.54	2.29	2.79
I.D. (B)	1.27	1.02	1.52
Ht. (C)	1.27	1.02	1.52

Eff. Parameters		
A _e mm ²	l _e mm	V _e mm ³
0.77	5.5	4.3

INDUCTANCE

AL value (nH/T ²)	Test conditions
525 ± 20%	10 kHz, 0.5 mT (For N = 5, use 0.09 mA), 25°C

CORE LOSSES

P _L max	Production lot limit Max avg	Test conditions
0.95 mW (220 mW/cm ³)	0.9 mW (200 mW/cm ³)	25 kHz, 200 mT, 100°C
-	-	-

COATING

Parylene rated for 130°C continuous operation.
Voltage breakdown rating 1000 V Min Wire-to-Wire.

NOTE

Spec. Modifications	Previous	Revised
2005.06.14	Losses: General F material	Losses: Detail as indicated