

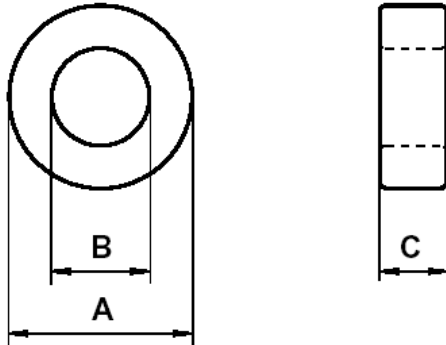

Specification for:
ZJ43813TC

110 Delta Drive
Pittsburgh, PA 15238
Phone: 412/696-1333
Fax: 412/696-0333
Email:magnetics@spang.com

DIMENSIONS



(mm)	Uncoated Nominal:	Coated Min:	Coated Max:
O.D. (A)	38.1	37.45	39.25
I.D. (B)	19	17.9	19.55
Ht. (C)	12.45	12.56	13.34

Eff. Parameters		
A _e mm ²	l _e mm	V _e mm ³
114.2	82.9	9462

INDUCTANCE

AL value (nH/T ²)	Test conditions
8365 ± 20%	Up to 200 kHz, 0.5 mT (For N = 1, use 4 mA), 25°C

ELECTRICAL LOSSES

tan δ / μ _i	Test conditions
≤ 15 · 10 ⁻⁶	100 kHz, 0.5 mT, 25°C

COATING

Epoxy rated for 200°C continuous operation.
Voltage breakdown rating 2000 V Min Wire-to-Wire.

NOTE

Spec. Modifications	Previous	Revised
2005.06.14	Bare Nom Ht = 12.7 LF: General J Material Breakdown voltage > 1,000 V	Bare Nom Ht = 12.45 LF: Detail as indicated Breakdown voltage > 2,000 V