

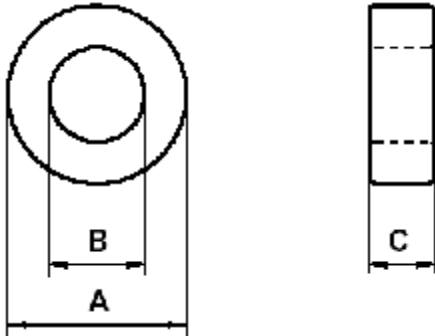

Specification for:
ZJ44416TC

110 Zeta Drive
 Pittsburgh, PA 15238
 Phone: 412/696-1333
 Fax: 412/696-0333
 Email: magnetics@spang.com

DIMENSIONS



(mm)	Uncoated Nominal:	Coated Min:	Coated Max:
O.D. (A)	44.3	43.12	45.98
I.D. (B)	19.0	17.52	19.98
Ht. (C)	15.7	15.55	16.85

Eff. Parameters		
A _e mm ²	l _e mm	V _e mm ³
187	88	16559

INDUCTANCE

A _L value (nH/T ²)	Test conditions	
13295±20%	10 kHz	0.5 mT (For N = 5, use 1.0mA), 25°C
≥ 9970	100 kHz	

ELECTRICAL LOSSES

tan δ / μ _i (Ref. Value only)	Test conditions
20·10 ⁻⁶	100 kHz, 0.5 mT, 25°C

COATING

Epoxxy rated for 200°C continuous operation.
Voltage breakdown rating 2000 V Min Wire-to-Wire.