

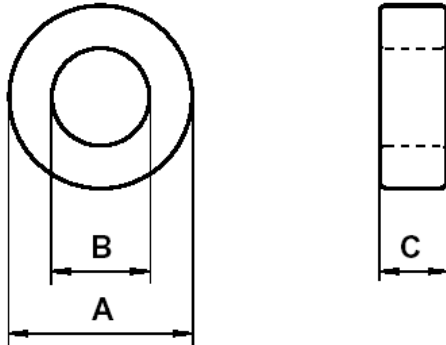

Specification for:  
**ZP42207TC**

110 Delta Drive  
Pittsburgh, PA 15238  
Phone: 412/696-1333  
Fax: 412/696-0333  
Email:magnetics@spang.com

**DIMENSIONS**



(mm)	Uncoated Nominal:	Coated Min:	Coated Max:
O.D. (A)	22.1	21.84	22.86
I.D. (B)	13.7	12.95	13.95
Ht. (C)	7.8	7.84	8.56

Eff. Parameters		
A <sub>e</sub> mm <sup>2</sup>	l <sub>e</sub> mm	V <sub>e</sub> mm <sup>3</sup>
32.1	54.1	1740

**INDUCTANCE**

AL value (nH/T <sup>2</sup> )	Test conditions
1875 ± 25%	10 kHz, 0.5 mT (For N = 5, use 1 mA), 25°C

**CORE LOSSES**

P <sub>L</sub> max	Production lot limit Max avg	Test conditions
217 mW (124 mW/cm <sup>3</sup> )	197 mW (113 mW/cm <sup>3</sup> )	100 kHz, 100 mT, 100°C

**COATING**

Epoxy rated for 200°C continuous operation.
Voltage breakdown rating 1500 V <sub>DC</sub> Min Wire-to-Wire.

**NOTE**

Spec. Modifications	Previous	Revised
2006.06.22	Bare Nom Ht = 7.92 Losses: General P material Breakdown voltage > 1,000 V	Bare Nom Ht = 7.8 Losses: Detail as indicated Breakdown voltage > 1,500 V <sub>DC</sub>