

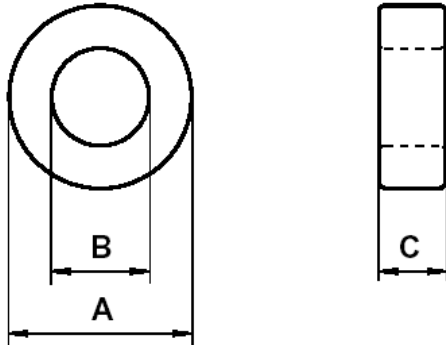

Specification for:
ZP42212TC

110 Delta Drive
Pittsburgh, PA 15238
Phone: 412/696-1333
Fax: 412/696-0333
Email:magnetics@spang.com

DIMENSIONS



(mm)	Uncoated Nominal:	Coated Min:	Coated Max:
O.D. (A)	22.1	21.84	22.86
I.D. (B)	13.7	12.95	13.95
Ht. (C)	12.6	12.66	13.34

Eff. Parameters		
A_e mm ²	l_e mm	V_e mm ³
51.9	54.1	2811

INDUCTANCE

AL value (nH/T ²)	Test conditions
3020 ± 25%	10 kHz, 0.5 mT (For N = 5, use 1 mA), 25°C

CORE LOSSES

P_L max	Production lot limit Max avg	Test conditions
349.1 mW (124 mW/cm ³)	317.4 mW (113 mW/cm ³)	100 kHz, 100 mT, 100°C

COATING

Epoxy rated for 200°C continuous operation.
Voltage breakdown rating 1500V_{DC} Min Wire-to-Wire.

NOTE

Spec. Modifications	Previous	Revised
2006.06.23	Bare Nom Ht = 12.7 Losses: General P material Breakdown voltage > 1,000 V	Bare Nom Ht = 12.6 Losses: Detail as indicated Breakdown voltage > 1,500 V _{DC}