

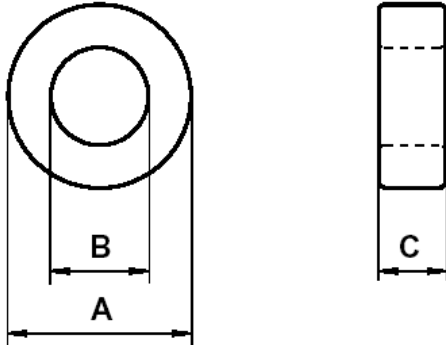

Specification for:  
**ZW44015TC**

110 Delta Drive  
Pittsburgh, PA 15238  
Phone: 412/696-1333  
Fax: 412/696-0333  
Email:magnetics@spang.com

**DIMENSIONS**



(mm)	Uncoated Nominal:	Coated Min:	Coated Max:
O.D. (A)	41.8	40.95	43.15
I.D. (B)	26.2	25.15	26.75
Ht. (C)	18.0	17.80	19.20

Eff. Parameters		
A <sub>e</sub> mm <sup>2</sup>	l <sub>e</sub> mm	V <sub>e</sub> mm <sup>3</sup>
138	103	14205

**INDUCTANCE**

AL value (nH/T <sup>2</sup> )	Test conditions
16816 ± 30%	10 kHz, 0.5 mT (For N = 5, use 0.44 mA), 25°C

**ELECTRICAL LOSSES**

tan δ / μ <sub>i</sub>	Production lot limit Average	Test conditions	
≤ 4.1 · 10 <sup>-6</sup>	≤ 3.5 · 10 <sup>-6</sup>	10 kHz	0.5 mT, 25°C
≤ 60 · 10 <sup>-6</sup>	≤ 50 · 10 <sup>-6</sup>	100 kHz	

**COATING**

Epoxy rated for 200°C continuous operation.
Voltage breakdown rating 2000 V Min Wire-to-Wire.